Chrono Safe

Burglar-resistant fittings for windows



Sobinco
OPENS YOUR LIFE

DESCRIPTION

The high-security Chrono Safe system is the ideal solution for giving your windows maximum protection against burglary.

CHARACTERISTICS

- Chrono Safe is available for both a frame groove of **14/18 mm** and a frame groove of **10/14 mm**.
- Manufactured from high-quality **non-corrosive materials**.
- **Quick assembly**: clampable in Euronut sections.
- **Extremely high load-bearing capacity**: RAL approved for vent weights **up to 170 kg**.
- The burglar-resistant Chrono Safe window system has **SKG approval with two stars**.

BURGLAR-RESISTANT COMPONENTS

The set, using the example of a turn-tilt window, contains the following burglar-resistant components:

- A number of **stainless steel mushroom head bolts**, pre-riveted onto aluminium connection pieces, corner transmissions and tilt bolt, which are attached to the Chrono Safe components and the rods in the vent.
- A number of **brass safety wedges** which are attached to the frame section by means of stainless steel clamping plates and self-tapping screws.
- A number of **zinc-alloy anti-lift devices and protection pieces** which are attached to the frame section and the vent section by means of clamping plates and self-tapping screws.
- Special zinc-alloy connection piece on the handle.
- Aluminium rods with special connections.

The burglar-resistant system is always operated by a **handle with cylinder**, available in 4 models.

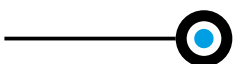
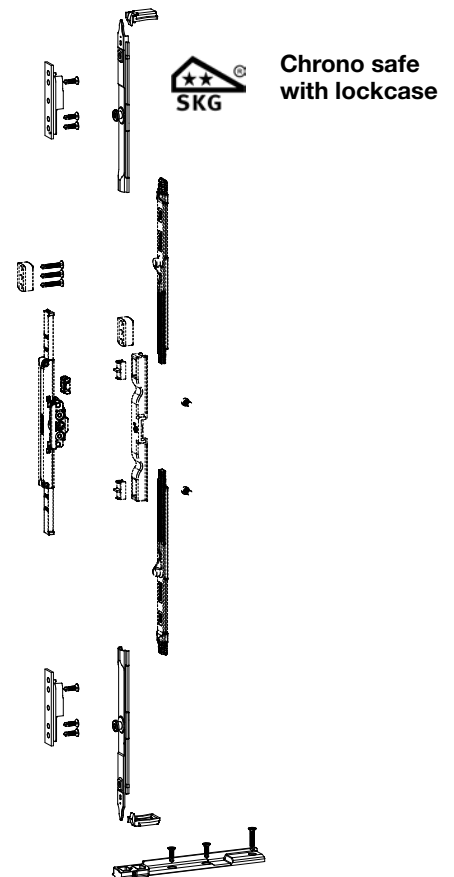
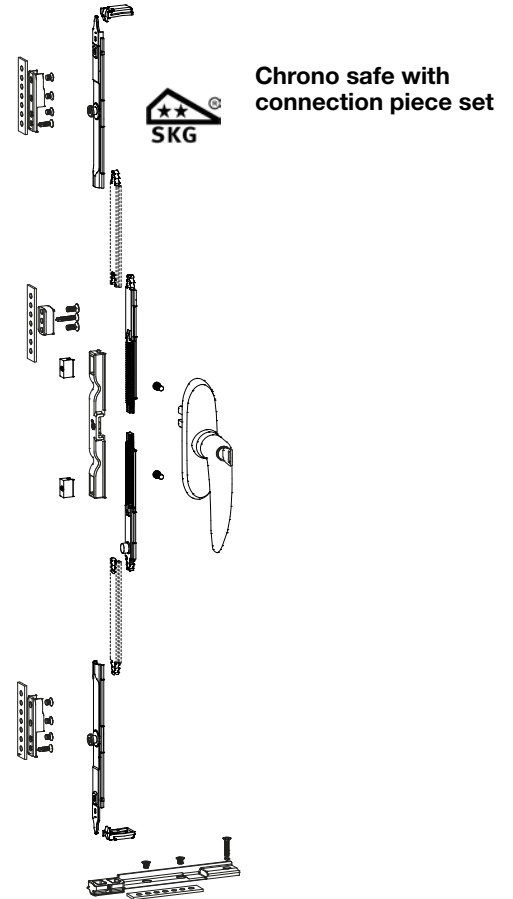

SIZE RANGE

Size range for turn-tilt or tilt-turn windows:

- Standard size range:
 - Fb = 450 (460*)-1700 mm
 - Fh = 600-2400 mm
- Size range (Fh > 2400 mm):
 - Fb = 670-1200 mm
 - Fh = 2400-2800 mm

Size range for side-hung windows:

- Standard size range:
 - Fb = 400-1700 mm
 - Fh = 600-2400 mm
- Size range (Fh > 2400 mm):
 - Fb = 670-1200 mm
 - Fh = 2400-2800 mm

Size range for bottom-hung windows:

- With vertical handle:
 - Fb = 550-1800 mm
 - Fh = 600-2400 mm
- With horizontal handle:
 - Fb = 600-2400 (1800*) mm
 - Fh = 400 (420*)-1200 mm

HINGE OPTIONS

- Visible hinges
- Concealed hinges
 - Chrono Invision Go
 - Chrono Invision Pro

ADVANTAGES

- **Chrono Safe is available for all window types:** turn-tilt windows, tilt-turn windows, side-hung windows, French casement windows and bottom-hung windows.

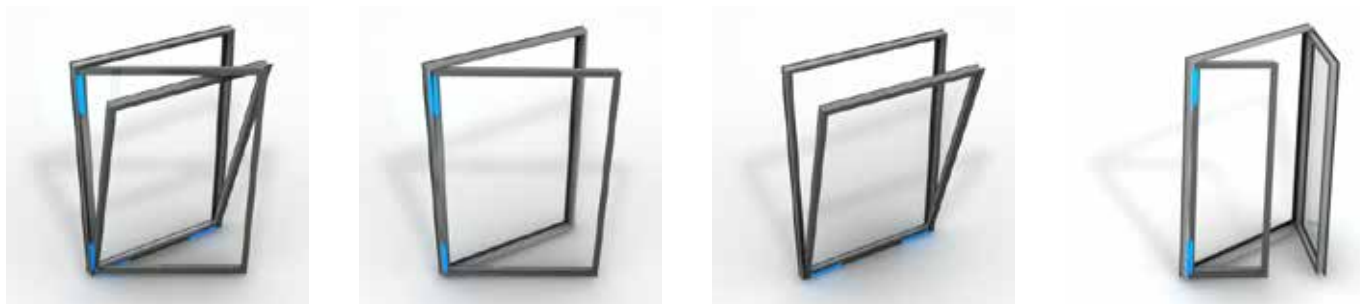

- Clampable Chrono Safe fittings are **available with visible hinges and concealed hinges: Chrono Invision Go and Chrono Invision Pro.**



Chrono Invision Go



Chrono Invision Pro

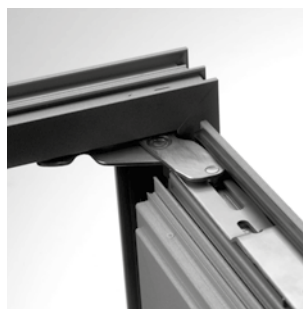

Chrono Invision Pro



Chrono Invision Pro

We are Sobinco. We get things done. We specialise in the development and production of innovative locking systems and components for the aluminium windows and doors industry.

At Sobinco **the entire production process takes place under one roof.** In this way we are able to manage and control the value creation chain from start to finish. This gives us **great flexibility** and allows us **to attain sustainable results over the short term.**

Innovation is our passion. Our creativity, expertise and craftsmanship provide a guarantee of added value which translates into **high-quality products, easy assembly, modularity, sustainability and aesthetic comfort.**

Driven by this passion, **our team** at all times endeavours to **improve our current products and develop new ones.** To this end, we listen to the market and to our customers.

We use **high-quality materials** for our product development. These products are **exhaustively tested in line with the strictest of guidelines and quality requirements.** Every product must satisfy these as a minimum and their ratings often exceed the required standards.

We have a **strong customer focus.** Not only in the development of our products, but also in our after-sales support, during the installation process and even long afterwards.

Sobinco is a financially viable and high-tech environment where our specialists can focus on their strengths. With more than 60 years in the business, you can rest assured that we are a reliable partner, ready to seize the opportunity. Nevertheless, we remain approachable. In short, **a family atmosphere, where there is mutual respect** for management, customers, partners and employees.

We are Sobinco. We get things done. We listen. We think in terms of opportunities. We are not afraid to roll up our sleeves.

VAN PARYS FAMILY

PEOPLE

COMPLETE SERVICE

VERTICAL INTEGRATION

Listen. Think. Do.

SUSTAINABLE GROWTH

INNOVATION

TOP QUALITY

FITTINGS FOR ALUMINIUM WINDOWS & DOORS

Waregemstraat 5 - 9870 Zulte - Belgium

T +32 9 388 88 81 - F +32 9 388 88 21

commercial@sobinco.com

www.sobinco.com

Sobinco
OPENS YOUR LIFE